

Instructions¹ for endocervical sample collection

Do not pre-wet swab in cobas[®] PCR Media or any other liquid before collection

ENDOCERVICAL SAMPLE

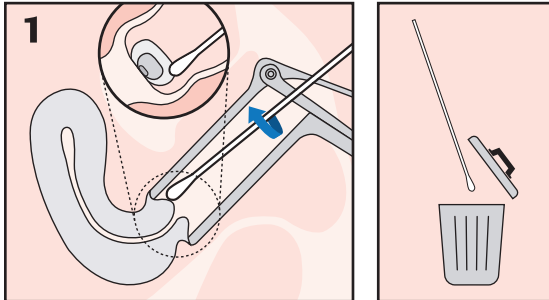

1. CLEAN:

Using the cleaning swab (swab **A** ) , remove **excess mucus** from the cervical os and surrounding mucosa. **Discard the swab** after use.

NOTE: Cleaning excess mucus from the cervical os is required to assure an adequate sample is obtained for processing. A large-tipped cleaning swab, such as Puritan 25-808 1PR (not provided) can be used.

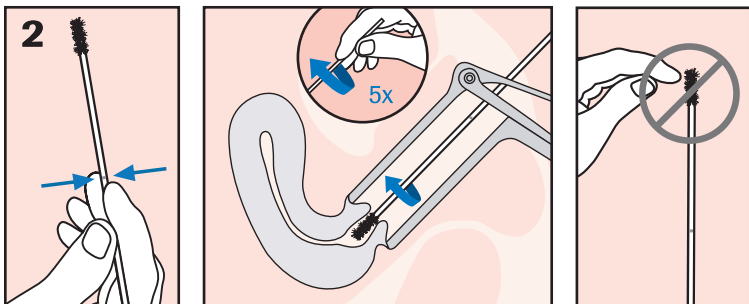

2. COLLECT:

To collect the specimen, hold swab **B**  with the scoreline above your hand and insert into the endocervical canal.

Gently **rotate the swab 5 times in one direction** in the endocervical canal. Do not over-rotate.

Carefully withdraw the swab, avoiding any contact with the vaginal mucosa.

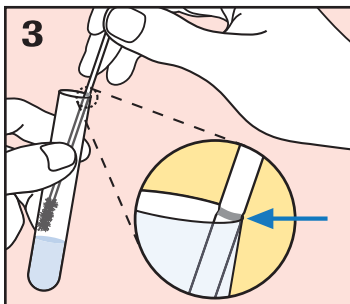

3. ALIGN:

Remove the cap from the **cobas[®] PCR Media** tube, holding the tube, **lower the swab** specimen into the tube until the visible **scoreline** on the swab shaft is aligned with the tube rim. The tip of the swab should be just above the media surface.

HANDLING PRECAUTIONS:
Use care to avoid splashing of contents.

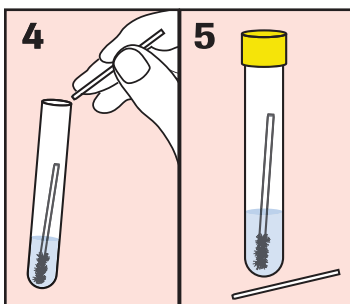

4. BREAK:

Carefully leverage the swab against the tube rim to **break the swab shaft at the scoreline**.

5. CLOSE:

Tightly re-cap the **cobas[®] PCR Media** tube. The specimen is now ready for transport.

Discard the top portion of the swab.

Transport: 2°C to 30°C ▪ **Stability of sample:** 12 months

THE SPECIMEN WILL BE REJECTED IF THERE IS:

- Presence of two swabs within the same tube
- No swab within the tube
- Excess of blood (>5%)



¹ Individuals collecting or directing the collection of samples should consult the complete instructions for use.